



30  
kN



FORGED STEEL IN  
MY BODY

15  
kN



160  $\varnothing$ 25  
mm



3/8"  
BSP



250  
bar



GO/GC  
3/8"  
BSP



200  
bar



300  
bar

900  
nm

24  
kg

20  
l/min

Hydraulic rotator FHR 3.000SF is cost-effective solution generally for seasonal use in forestry, agriculture, road and building construction, general cargo and material handling.

Rotator's upper mount is applied in EYE form factor of the knuckle joint. Robust and tough built to withstand even overloads. The wide of eye is common standard width 60mm and the knuckle pin diameter 25mm.



FHL 01-A/B-60/25



FHL 01B-A/B-60/25

Rotator lower mount is applied in SQUARE shape FLANGE form factor to mount direct on grapple / tool surface by fixing with screws



140  
 $\varnothing$ 17(x4)  
mm



GO/GC  
3/8"  
BSP

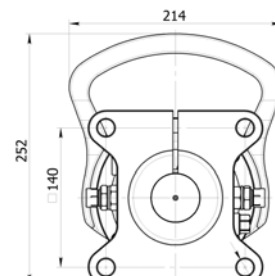
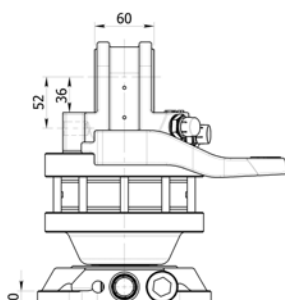
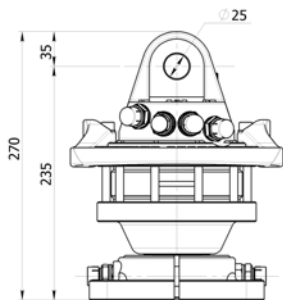

$\varnothing$ 17(4x)